

WARNING

DO NOT EXCEED WORKING LOAD LIMIT.
USE ONLY G80 & G100 COMPATIBLE COMPONENTS FOR OVERHEAD LIFTING.

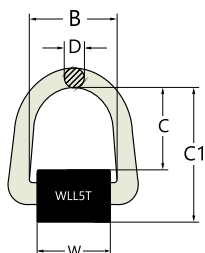

Weld on D Lashing Ring



Safe Lifters make Weld on Pivoting D Link can be welded on any carbon steel surface as a lifting point, or to be used as a fixed anchor point for spreader beam attachment. Can also be used as an anchor point for load restraint applications.

- Manufactured from treated alloy steel with safety factor of 4:1
- Conforms to EN1677, Test Certificates available upon request.
- Welding instructions supplied with each unit

CODE	WLL	Wt.	DIMENSIONS				
	tonne	kg	B mm	D mm	C mm	C1 mm	W mm
SLR344-2T	2	0.47	42	14	51	88	40
SLR344-3T	3	0.69	45	17	54	94	42.5
SLR344-5T	5	1.46	55	22	66	118	61
SLR344-8T	8	2.50	70	26.5	84	141	70.5

Universal Weld on Hook

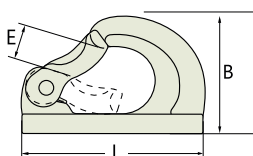

Safe Lifters Weld-on Hooks are a versatile hook for lifting and spreader beam attachment applications, can also be used for any fixed anchor point after welding the hook on.

- Made from G80 alloy steel with safety factor of 4:1
- Conforms to EN1677, Test Certificates available upon request.
- Welding instructions supplied with each unit

CODE	CHAIN SIZE	WLL	B.L	Wt.	DIMENSIONS		
	mm	tonne	tonne	kg	B mm	E mm	L mm
SLR091-1T	6	1.0	5	0.48	78	23	98
SLR091-2T	7, 8	2.0	10	0.83	92	30	114
SLR091-3T	10	3.2	15	1.20	106	33	129
SLR091-5T	13	5.3	25	2.46	133	35	171
SLR091-8T	16	8.0	40	3.26	136	40	177
SLR091-10T	18	10	50	5.17	169	51	223



WARNING

DO NOT EXCEED WORKING LOAD LIMIT.

USE ONLY G80 & G100 COMPATIBLE COMPONENTS FOR OVERHEAD LIFTING.



Load Binding Chains

Binder chain assemblies are suitable for truckers, contractors, oil field and highway crews. Grab hook at each end for load binding, hauling, towing and similar applications. Available in Grade 30, 70 and 80, and a variety of sizes and lengths.



THIS TYPE OF CHAIN IS NOT TO BE USED FOR OVERHEAD LIFTING

CHAIN SIZE (INCHES)	STANDARD LENGTHS (FT.)	WORKING LOAD LIMITS (LBS.)		
		GRADE 30	GRADE 70	GRADE 80
1/4	20	1,040	3,150	3,500
5/16	20	1,650	4,700	4,500
3/8	20	3,340	6,600	7,300
1/2	20	4,180	11,300	13,000
5/8	20	6,750	15,800	20,300

Clevis Grab Hooks

- For use with Grade 30 chains only

Size	WLL (lbs)	Dimensions (inches)				Weight (lbs)
		A	B	C	D	
1/4	2,600	0.35	0.38	0.39	1.97	0.45
5/16	3,900	0.41	0.43	0.44	2.27	0.74
3/8	5,400	0.47	0.47	0.51	2.63	1.14
7/16	7,200	0.67	0.55	0.58	2.79	1.45
1/2	9,200	0.73	0.62	0.69	3.13	2.30

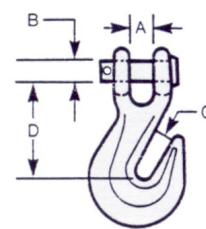

- For use with Grade 70 and 80 chains only

Size	WLL (lbs)	Dimensions (inches)				Weight (lbs)
		A	B	C	D	
1/4	3,150	0.36	0.38	0.39	1.97	0.46
5/16	4,700	0.38	0.44	0.43	2.28	0.75
3/8	6,600	0.47	0.47	0.50	2.61	1.10
7/16	8,800	0.67	0.55	0.58	2.79	1.53
1/2	11,300	0.76	0.62	0.67	3.13	2.34

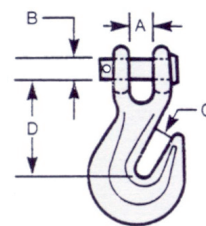

WARNING

DO NOT EXCEED WORKING LOAD LIMIT.
USE ONLY G80 & G100 COMPATIBLE COMPONENTS FOR OVERHEAD LIFTING.



ESTD.1986

Safe Lifters

DEALERS IN LIFTING EQUIPMENTS

Pundol Apartments, Shop No. 5 & 6,160 M.G. Road, Pune - 411001. (India)

Tel. : +91-20-6708 8100 Fax : +91 - 20 - 6708 8101

Email : sales@safelifters.com Website : www.safelifters.com

Ratchet Load Binder

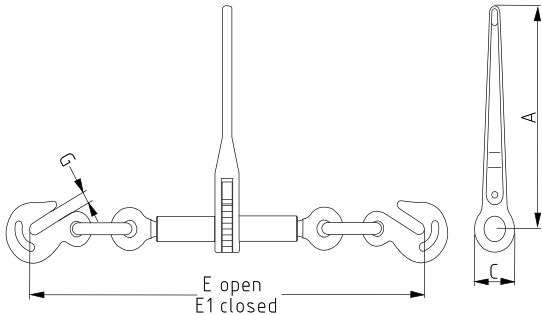

- Designed for heavy duty transport use
 - Ratchet handle allows infinite adjustment and continuous take-up
 - Short reach hooks allow for maximum take-up
- Standard: EN 12195
 Material: Forged carbon steel
 Factor of safety: 3.5 to 1
 Construction: Quenched & tempered
 Proof load: Individually proof tested to 2 times of working load limit

Load binder ratchet type								
Size	WLL (lbs)	MBL (lbs)	A (in)	C (in)	E (in)	E1 (in)	G (in)	Net weight (lbs)
5/16" - 3/8"	5400	19000	13.98	2.56	22.95	29.29	0.50	10.36
3/8" - 1/2"	9200	33000	13.98	2.56	23.74	30.24	0.65	11.24
1/2" - 5/8"	13000	46000	13.98	2.56	27.17	33.86	0.73	15.83

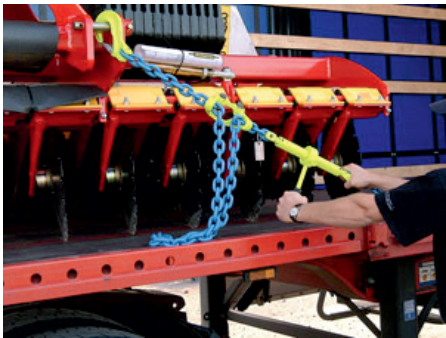



TUFF WEBLIFT

Pundol Apartments, Shop No. 5 & 6, 160 M.G. Road, Pune - 411001. (India)
 Tel. : +91 - 20 - 6708 8100 Fax : +91 - 20 - 6708 8101
 Email : sales@safelifters.com Website : www.safelifters.com

TUFF RATCHET LASHING



Patent Model
25 MM / 2000 KGS

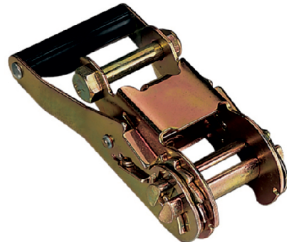

35 MM / 3000 KGS

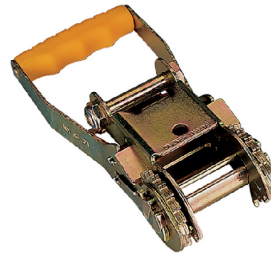

Patent Model
50 MM / 5000 KGS

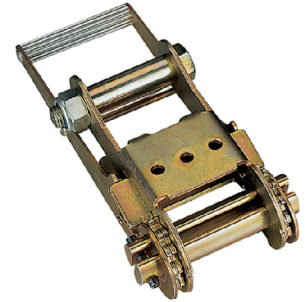

75 MM / 10000 KGS

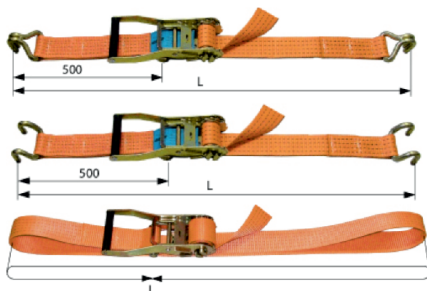
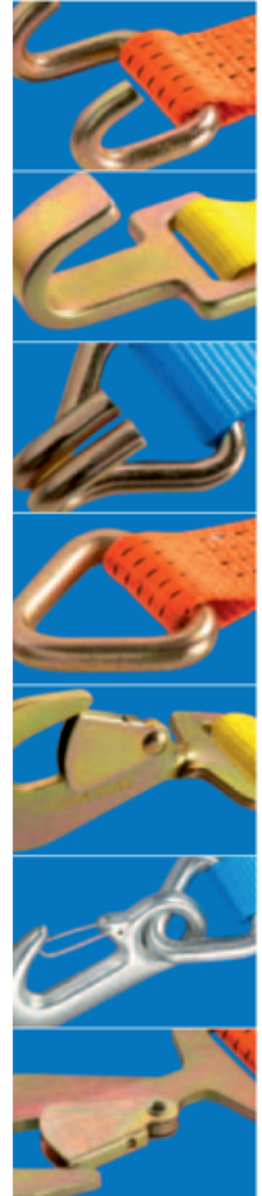

HOW TO ORDER YOUR RATCHET

1. CAPACITY
2. WIDTH OF BELT
3. LENGTH OF RATCHET (L)
4. TYPE OF END FITTING



TUFF WEBLIFT

Pundol Apartments, Shop No. 5 & 6, 160 M.G. Road, Pune - 411001. (India)

Tel. : +91 - 20 - 6708 8100

Fax : +91 - 20 - 6708 8101

Email : sales@safelifters.com

Website : www.safelifters.com

TUFF CAMBUCKLE LASHING



25 MM

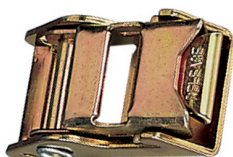

25 MM

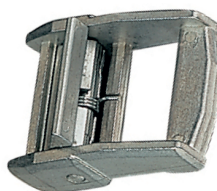

35 MM



50 MM

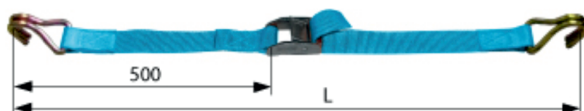

TUFF WEB WINCHES



WELD ON WINCH



SLIDE ON WINCH



PORTABLE WINCH



LASHING WINCH