

WARNING

DO NOT EXCEED WORKING LOAD LIMIT.
USE ONLY G80 & G100 COMPATIBLE COMPONENTS FOR OVERHEAD LIFTING.



TUFF PRO PULLING & LIFTING MACHINE

Working load limit (WLL) 800KG-5400KG

Light weight, compact, high strength aluminium alloy housing with a large flat bottom surface for increased stability in horizontal as well as vertical working position.

Features:

- Forward and reversing levers in tandem provide slim design and assure power transfer along the centre line.
- Overload protection is by a shearing pin in the forward lever. Spare shear pins are conveniently located in the carrying handle or operating lever. A broken pin can be replaced without removing the load.
- A lever disengages the rope clamp system allowing easy, smooth installation of the wire rope.
- The parallel arrangement of the clamping system protects the wire rope by distributing the clamping forces evenly. A long rope advance per each lever stroke increases the working speed.
- The large opening in the top of the unit allows easy cleaning: simply flush the unit with water, apply motor oil for lubrication and the puller is again ready for use.

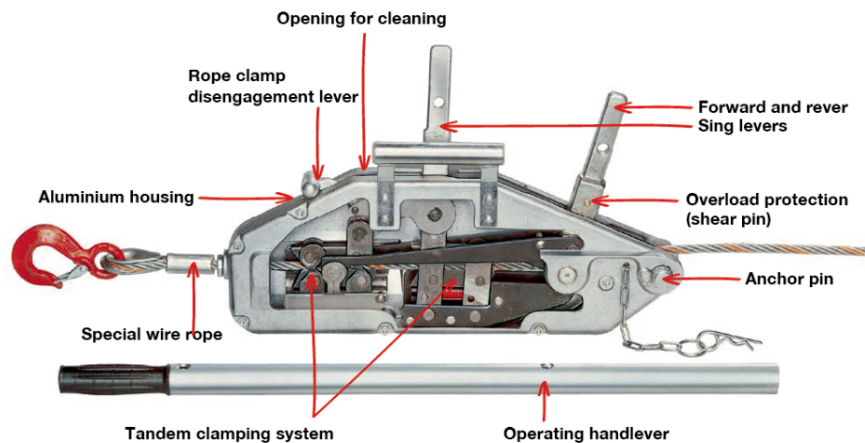
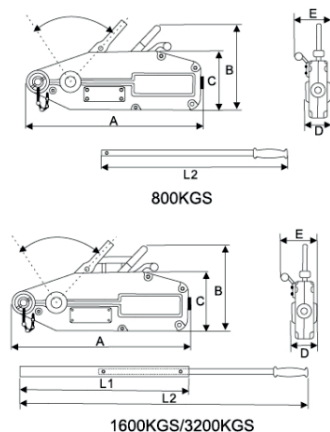

Model	Rated Forward Hand power	Rated Capacity	Rated forward Travel (Swing it forward and backward)	Rope Diameter	Wire ropesafety Factor load Capacity	Safety factor & static load capacity	Max. Travelling Load	A	B	C	D	E	L1 [cm]	L2 [cm]	Net Weight
Y800	341	800	≥52	8.3	5	5	1200	426	235	168	60	64	80	80	14.6
Y1600	438	1600	≥55	11	5	5	2400	545	280	190	72	97	80	120	26.4
Y3200	438	3200	≥28	16	5	5	4000	660	325	230	91	116	80	120	49.3
Y5400	745	5400	≥30	20	6	6	8000	932	420	300	155	152	80	120	98

⚠ WARNING
DO NOT EXCEED WORKING LOAD LIMIT.
USE ONLY G80 & G100 COMPATIBLE COMPONENTS FOR OVERHEAD LIFTING.



Safe Lifters

ESTD.1986

DEALERS IN LIFTING EQUIPMENTS

Pundol Apartments, Shop No. 5 & 6, 160 M.G. Road, Pune - 411001. (India)

Tel. : +91 - 20 - 6708 8100

Fax : +91 - 20 - 6708 8101

Email : sales@safelifters.com

Website : www.safelifters.com

Pulling & Lifting Machines



Accepted & Widely used by:

- ☐ Railways
- ☐ Mines and Quarries
- ☐ Navigator
- ☐ Electricity Board's
- ☐ Dockyards
- ☐ Road Transports
- ☐ Heavy Industries etc.

About the machine : Multipurpose, Portable, Universal, Gearless, Hand operated Pulling and Lifting machine, Supplied complete with telescopic, operating handle and standard Length of superflex steel fibre-mixed core wire-rope fitted with Hook or Shackle at one end and fused and tapered at the other end

Technical Specifications :	HT-7	HT-13	HT-20	HT-35	HT-58
Dimensions (Approx)	515x265x110	600 x 360x155	620-360-155	720x400x160	810x465x190
Capacity (SWL)(Kgs) Lifting, Pulling	750, 1250	1600, 2600	2000, 3000	3200, 5200	5000, 8000
Length of Telescopic operating handle (Approx.)	54/72 cm	66/104 cm	70/130 cm	79/118 cm	120/145 cm
Effort at full load (Approx.) Kgs	40	50	50	60	70
Rope travel per Return stroke (Approx) mm	40	55	50	36	30
Diameter of wire Rope (mm)	8.0	11.3	12.0	16.3	20.0
Standard Length with Each machine (meters)	10		20		201010
Breaking Load of wire rope (Approx)	4.5 Tons 9.0 Tons	10.0 Tons	18.0 Tons	24.0 Tons	
Weight (Approx) Kgs					

Specifications given are indicative and are subject to change.

Exclusive Features :

- Casing : Made from CRC sheet (Galvanised) or Graded Aluminium for light weight a high factor of safety.
- Jaw : Made from Special Alloy Steel, Accurately Machined, so as to avoid slippage of wire rope.
- Jaw Limites : Are made from special steel & heat treated for greater strength.
- Hooks/D-shackles : Fitted with Alloy steel Forged Hooks or D-shackle to make it feasible to be able to fit it at any place
- Wore Ropes : Superflex Steel Fiber -mixed are, manufactured as IS. 2266

⚠ WARNING
DO NOT EXCEED WORKING LOAD LIMIT. USE ONLY G80 & G100 COMPATIBLE COMPONENTS FOR OVERHEAD LIFTING.



Safe Lifters

ESTD.1986

DEALERS IN LIFTING EQUIPMENTS

Pundol Apartments, Shop No. 5 & 6, 160 M.G. Road, Pune - 411001. (India)

Tel. : +91 - 20 - 6708 8100

Fax : +91 - 20 - 6708 8101

Email : sales@safelifters.com

Website : www.safelifters.com

Hand Operated Crab Winch

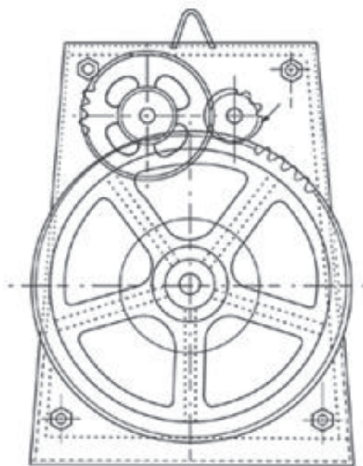

Side View Cross Section

**Hand operated,
Double Purchase Crab Winch**

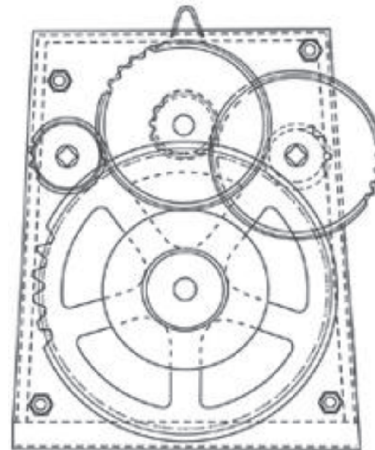
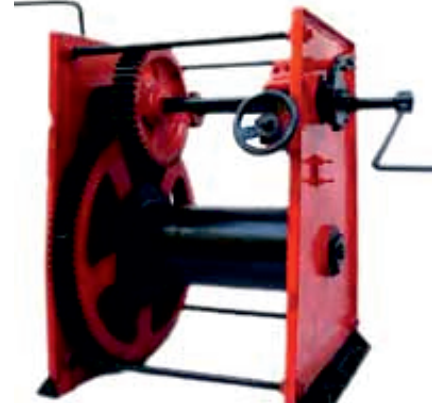

Side View Cross Section

**Hand operated,
Treble Purchase Crab Winch**

Hand operated Crab winch with square type side plate to cover big pinion and reinforced by side angle, fabricated seamless pipe drum, brake with shoe, ratchet, pawl and handles

To Lift Direct From Barrel	Drum Dia	Drum Length	Thickness of Side Plate	Main Shaft Dia	No. of Driving Shaft	Dia of Driving Shaft	Dia of Tie Rod	No. of Tie Rod	Height	Width	Purchase	Dia Main Pinion	Flange Dia	Weight of Winch
1 Ton	5 1/2"	16"	6mm	32mm	2	1 1/8"	16mm	4	25"	21"	Double	17 1/4"	9"	150
1.5 Ton	5 1/2"	18 1/2"	6mm	32mm	2	1 1/4"	16mm	4	29"	23"	Double	21 1/4"	9"	175
2 Ton	6 5/8"	22"	8mm	40mm	2	1 3/8"	20mm	4	35"	27"	Double	26 1/4"	11"	250
3 Ton	6 5/8"	24"	8mm	45mm	2	1 1/2"	22mm	4	39"	30"	Double	30"	11"	280
5 Ton	8 5/8"	30"	10mm	50mm	2	1 3/4"	25mm	4	48"	34"	Double	35 5/8"	13"	425
7.5 Ton	8 5/8"	30"	10mm	50mm	3	1 3/4"	25mm	4	48"	34"	TRIPLE	35 5/8"	13"	650
10 Ton	8 5/8"	34"	11mm	65mm	3	1.875"	32mm	4	48"	35"	TRIPLE	34"	16"	750

Specifications given are indicative and are subject to change.

WARNING

DO NOT EXCEED WORKING LOAD LIMIT.
USE ONLY G80 & G100 COMPATIBLE COMPONENTS FOR OVERHEAD LIFTING.



Worm Gear Winch

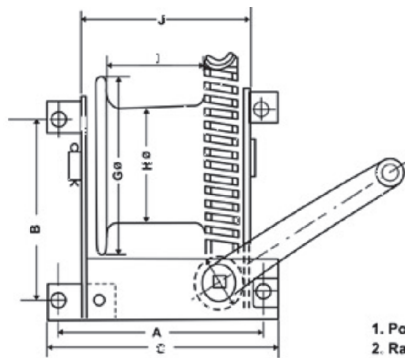

Front View

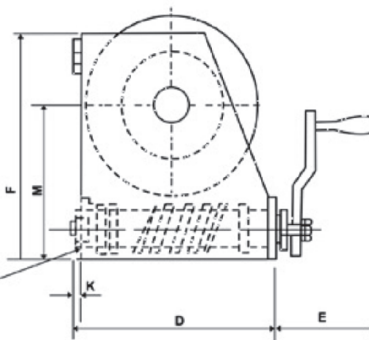

Side View

1. Powl
2. Ratchet
3. Bearing
4. Fiber washer



Capacity (Kg)	A	B	C	D	E	F	G	H	I	J	K	L	M
250	204	104	221	165	175	213	118	69	104	170	6.7	14	95
500	254	215	317	254	181	263	203	130	130	222	9.3	14	182
1000	254	215	317	254	181	263	203	130	130	222	12.7	17	182
1500	310	215	360	275	235	267	200	129	177	267	28.0	14	178
2000	349	241	381	304	250	300	300	184	206	305	12.7	17	210
3000	349	241	381	304	260	308	300	184	206	305	15.5	19	210
5000	400	315	480	570	400	500	335	225	250	460	20.0	33	315

All dimensions are in mm

Specifications given are indicative and are subject to change.

Poultry & Boat Winch



WARNING

DO NOT EXCEED WORKING LOAD LIMIT.

USE ONLY G80 & G100 COMPATIBLE COMPONENTS FOR OVERHEAD LIFTING.



TUFF PRO SPUR GEAR COMPACT WINCH

WORKING LOAD LIMIT (WLL) 1200LBS, 1800LBS, 2600LBS
Standard Features include:

- Winching housing and rope drum from robust steel plate for high versatility
- Rope drum bush bearings for flawless rope lead-off
- Spur gear drive for optimal efficiency
- Compact design
- Easy and quick mounting onto walls, poles, towers etc.
- Pivotable handle
- Automatic load pressure brake for safe holding and extremely sensitive lowering of the load
- Unintentional brake release is prevented even with swinging loads
- Suitable for operation in ambient temperatures of -10° to +50°

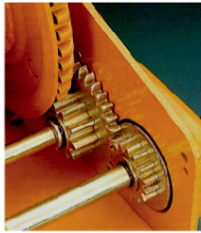

Gears

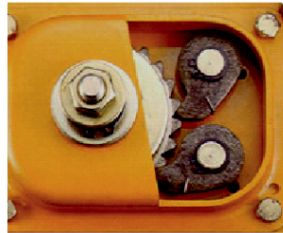

Double brake pawl

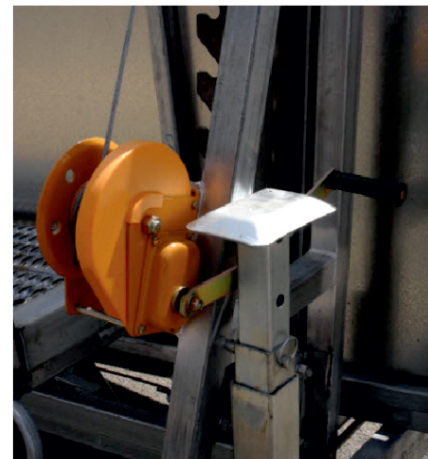
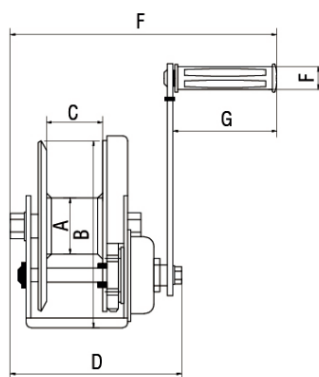
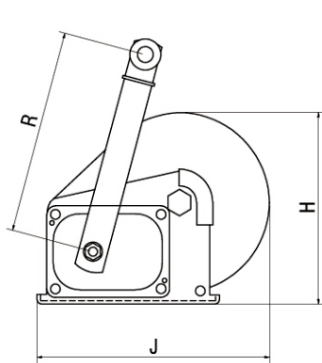

Rated Capacity [lb]	Test Load [KN]	Transmission Ratio	Hand Operated Strength [N]	A [mm]	B [mm]	C [mm]	D [mm]	E [mm]	F [mm]	G [mm]	H [mm]	J [mm]	R [mm]	Net Weight (no wire rope) [kg]
1200	8	4.2:1	180	Ø48	Ø134	51	157	Ø27	273	110	156	184	208	3.7
1800	12	5:1	190	Ø60	Ø180	60	190	Ø27	288	110	203	246	319	8.1
2600	17.5	10:1	190	Ø75	Ø180	63	209	Ø27	307	110	216	294	319	10.3