

⚠ WARNING

DO NOT EXCEED WORKING LOAD LIMIT.
USE ONLY G80 & G100 COMPATIBLE COMPONENTS FOR OVERHEAD LIFTING.



Safe Lifters

Pundol Apartments, Shop No. 5 & 6, 160 M.G. Road,
Pune - 411001. (India) Tel +91 20 66013783 / 84 / 85 / 86
Fax +91 20 26350832 Email : safelifters@eth.net

Grade 30 Eye Hoist Hook with safety latch

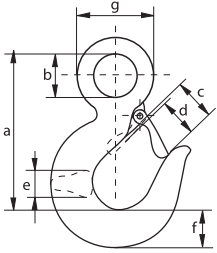

- **Material** : Carbon steel
- **Safety factor** : MBL equals 4 x WLL

working load limit	length	diameter eye inside	width opening	width opening	thickness	width	diameter eye outside	weight per pc
tons	a mm	b mm	c mm	d mm	e mm	f mm	g mm	kg
0.8	82	19	24	20	15	20	38	0.27
1	93	25	26	22	18	22	45	0.4
1.6	103	28	27	23	20	27	52	0.55
2	120	32	32	27	23	30	60	0.83
3.2	147	40	41	35	29	38	74	1.9
5	187	51	51	43	37	46	97	3.5
7.5	230	64	61	53	46	58	122	6.9
10	256	72	65	58	58	66	136	10.5
15	318	90	85	78	63	77	168	17.5

Grade 80 Swivel Hoist Hook with safety latch

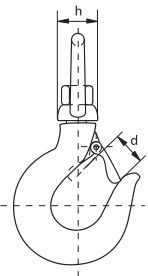
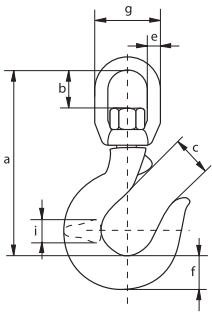

- **Material** : Carbon steel
- **Safety factor** : MBL equals 4 x WLL

working load limit	length	length inside	width opening	width opening	diameter	width	diameter	width	thickness	weight per pc
tons	a mm	b mm	c mm	d mm	e mm	f mm	g mm	h mm	i mm	kg
0.8	116	28	24	20	11	20	52	30	15	0.45
1	145	36	26	22	14	22	67	36	18	0.9
1.6	165	49	27	23	17	27	81	42	20	1.3
2	175	45	32	27	17	30	81	42	23	1.6
3.2	214	55	41	35	21	38	106	64	29	3.8
5	264	70	51	43	26	46	129	77	37	6.9
7.5	308	74	61	53	29	58	148	92	46	10.6
10	344	86	65	58	35	66	165	105	58	16
15	427	114	85	78	40	77	200	130	63	27
20	505	125	90	82	48	90	235	146	82	60

⚠ WARNING

DO NOT EXCEED WORKING LOAD LIMIT.
USE ONLY G80 & G100 COMPATIBLE COMPONENTS FOR OVERHEAD LIFTING.



Safe Lifters

Pundol Apartments, Shop No. 5 & 6, 160 M.G. Road,
Pune - 411001. (India) Tel +91 20 66013783 / 84 / 85 / 86
Fax +91 20 26350832 Email : safelifters@eth.net



Swivels Eye - Eye

- **Material** : High tensile steel, Quenched and Tempered
- **Safety factor** : MBL equals 4 x WLL
- **Standard** : generally to RR-C-271, Type VII, Class 2
- **Certification** : test certificates can be supplied upon request

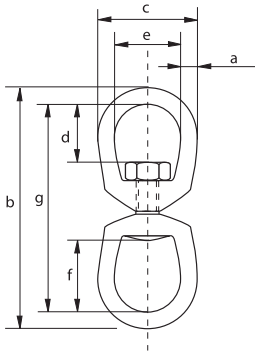

working load limit	diameter	length outside	width outside	length inside	width inside	length inside	length	weight per pc
tons	a mm	b mm	c mm	d mm	e mm	f mm	g mm	kg
0.39	6	87	32	17	19	27	75	0.1
0.57	8	106	41	21	25	32	90	0.18
1.02	10	130	51	24	32	38	110	0.32
1.6	13	164	64	33	38	51	138	0.6
2.4	16	199	76	40	44	60	167	1.13
3.3	19	221	89	44	51	67	183	1.82
4.5	22	257	102	52	57	78	213	2.83
5.7	25	295	114	59	64	89	245	4.06
8.2	32	355	143	68	80	94	291	7.43
20.5	38	511	178	106	102	106	435	20.8



Swivels Jaw - Eye

- **Material** : High tensile steel, Quenched and Tempered
- **Safety factor** : MBL equals 4 x WLL
- **Standard** : generally to RR-C-271, Type VII, Class 3
- **Certification** : test certificates can be supplied upon request

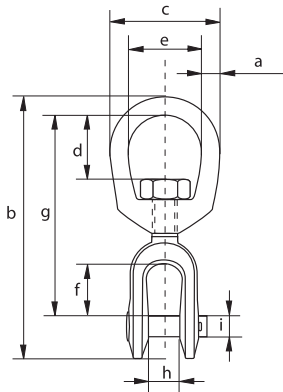

working load limit	diameter	length	width outside	length inside	width inside	length inside	length	width inside	diameter pin	weight per pc
tons	a mm	b mm	c mm	d mm	e mm	f mm	g mm	h mm	i mm	kg
0.39	6	86	32	17	19	22	67	12	6	0.11
0.57	8	98	41	21	25	22	75	13	8	0.17
1.02	10	121	51	24	32	27	92	16	10	0.32
1.6	13	154	64	33	38	33	114	19	13	0.65
2.4	16	186	76	40	44	38	135	24	16	1.12
3.3	19	211	89	44	51	44	154	28	19	1.76
4.5	22	242	102	52	57	52	178	30	22	2.66
5.7	25	297	114	59	64	71	217	44	28	4.46
8.2	32	341	143	68	80	71	248	52	35	7.14
20.5	38	529	178	106	102	112	375	73	57	24.8

⚠ WARNING
DO NOT EXCEED WORKING LOAD LIMIT.
 USE ONLY G80 & G100 COMPATIBLE COMPONENTS FOR OVERHEAD LIFTING.



Safe Lifters

Pundol Apartments, Shop No. 5 & 6, 160 M.G. Road,
 Pune - 411001. (India) Tel +91 20 66013783 / 84 / 85 / 86
 Fax +91 20 26350832 Email : safelifters@eth.net

S-Hooks

Standard Type



- Material** : mild steel
- Finish** : electro-galvanized

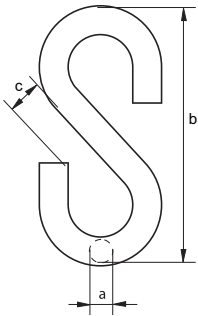

diameter		length	opening	weight per 100 pcs
a	mm	b	c	kg
3		25	6	0.3
4		35	8	0.8
5		45	9	1.3
6		55	10	2.4
7		65	17	4.3
8		75	20	6.9

S-Hooks

Customised Type

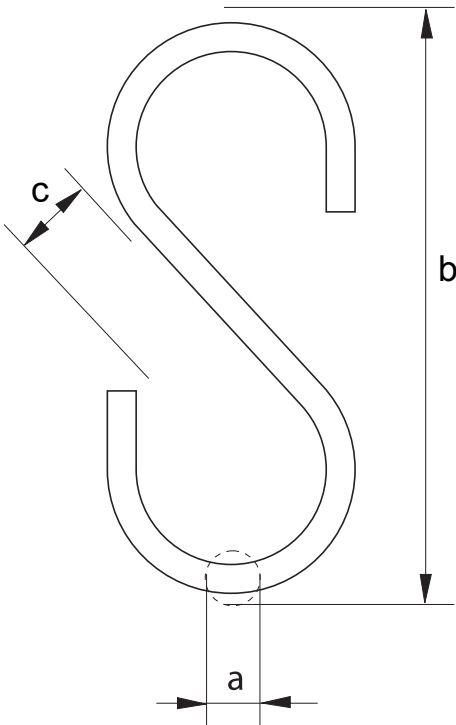

a= _____
 b= _____
 c= _____
 Radius = _____
 Working Load Limit = _____

Notes: _____

