

G-210 / S-210

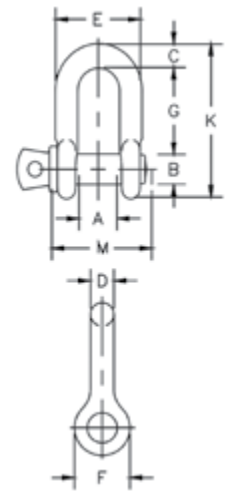

- Forged, Quenched & Tempered, with alloy pins.
- Working Load Limit and Grade 6 permanently shown on every shackle.
- Hot-dip galvanized (G) or self colored (S).
- Sizes 3/8 inch and below are mechanically galvanized.
- Fatigue rated at 1-1/2 times the Working Load Limit at 20,000 cycles.
- Shackles can be furnished proof tested with certificates to designated standards, such as ABS, DNV, Lloyds, or other certifications. Proof testing and certification available when requested at the time of order, charges will apply.
- Approved for use at -40° C (-40° F) to 204° C (400° F).
- All 209 and 210 shackles can meet charpy requirements of 42 Joules (31 ft-lb) avg. at -20° C (-4° F) upon special request.
- Meets or exceeds all requirements of ASME B30.26.
- Type Approval certification in accordance with ABS 2016 Steel Vessel Rules and ABS Guide for Certification of Lifting Appliances available. Certificates available when requested at time of order and may include additional charges.
- G-210 Screw pin anchor shackles meet the performance requirements of Federal Specification RR-C-271H, Type IVB, Grade A, Class 2, except for those provisions required of the contractor.
- Look for the Red Pin®... the mark of genuine Crosby quality.



G-210 / S-210 Screw Pin Chain Shackles

Nominal Size (in)	Working Load Limit (t)	Stock No.		Weight Each (kg)	Dimensions (mm)											Tolerance (+ / - mm)	
		G-210	S-210		A	B	C	D	E	F	G	K	L	M	G	A	
1/4	0.5	1019150	1019169	.05	11.9	7.85	6.35	6.35	24.6	15.5	22.4	40.4	4.85	35.1	1.50	1.50	
5/16	0.75	1019178	1019187	.08	13.5	9.65	7.85	7.85	29.5	19.1	26.2	48.5	5.60	42.2	1.50	1.50	
3/8	1	1019196	1019203	.13	16.8	11.2	9.65	9.65	35.8	23.1	31.8	58.5	6.35	51.5	3.30	1.50	
7/16	1.5	1019212	1019221	.20	19.1	12.7	11.2	11.2	41.4	26.9	36.6	67.5	7.85	60.5	3.30	1.50	
1/2	2	1019230	1019249	.27	20.6	16.0	12.7	12.7	46.0	30.2	41.4	77.0	9.65	68.5	3.30	1.50	
5/8	3.25	1019258	1019267	.57	26.9	19.1	15.7	16.0	58.5	38.1	51.0	95.5	11.2	85.0	3.30	1.50	
3/4	4.75	1019276	1019285	1.20	31.8	22.4	20.6	19.1	70.0	46.0	60.5	115	12.7	101	6.35	1.50	
7/8	6.5	1019294	1019301	1.43	36.6	25.4	24.6	22.4	81.0	53.0	71.5	135	12.7	114	6.35	1.50	
1	8.5	1019310	1019329	2.15	42.9	28.7	25.4	25.4	93.5	60.5	81.0	151	14.2	129	6.35	1.50	
1-1/8	9.5	1019338	1019347	3.06	46.0	31.8	31.8	28.7	103	68.5	91.0	172	16.0	142	6.35	1.50	
1-1/4	12	1019356	1019365	4.11	51.5	35.1	35.1	31.8	115	76.0	100	191	17.5	156	6.35	3.30	
1-3/8	13.5	1019374	1019383	5.28	57.0	38.1	38.1	35.1	127	84.0	111	210	19.1	174	6.35	3.30	
1-1/2	17	1019392	1019409	7.23	60.5	41.4	41.1	38.1	137	92.0	122	230	20.6	187	6.35	3.30	
1-3/4	25	1019418	1019427	12.1	73.0	51.0	54.0	44.5	162	106	146	279	25.4	231	6.35	3.30	
2	35	1019436	1019445	19.2	82.5	57.0	60.0	51.0	184	122	172	312	31.0	263	6.35	3.30	
2-1/2	55	1019454	1019463	32.5	105	70.0	66.5	66.5	238	145	203	377	35.1	330	6.35	6.35	

6:1 Design Factor. Maximum Proof Load is 2 times the Working Load Limit. For Working Load Limit reduction due to side loading applications, see Warnings & Applications.



G-209/S-209



- Meets performance requirements of Grade 6 shackles.
- Forged, Quenched & Tempered, with alloy pins.
- Working Load Limit and Grade 6 permanently shown on every shackle.
- Hot-dip galvanized (G) or self colored (S).
- Sizes 3/8 inch and below are mechanically galvanized.
- Fatigue rated at 1-1/2 times the Working Load Limit at 20,000 cycles.
- Shackles can be furnished proof tested with certificates to designated standards, such as ABS, DNV, Lloyds, or other certifications. Proof testing and certification available when requested at the time of order, charges will apply.
- Approved for use at -40° C (-40° F) to 204° C (400° F).
- All 209 and 210 shackles can meet charpy requirements of 42 Joules (31 ft-lb) avg. at -20° C (-4° F) upon special request.
- Meets or exceeds all requirements of ASME B30.26.
- Type Approval certification in accordance with ABS 2016 Steel Vessel Rules and ABS Guide for Certification of Lifting Appliances available. Certificates available when requested at time of order and may include additional charges.
- G-209 Screw pin anchor shackles meet the performance requirements of Federal Specification RR-C-271H, Type IVA, Grade A, Class 2, except for those provisions required of the contractor.
- Look for the Red Pin®... the mark of genuine Crosby quality.

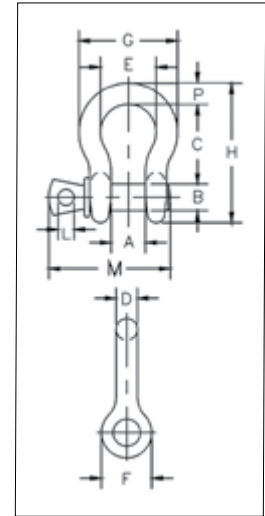

G-209 / S-209 Screw Pin Anchor Shackles

Nominal Size (in)	Working Load Limit (t)	Stock No.		Weight Each (kg)	Dimensions (mm)												Tolerance (+ / - mm)	
		G-209	S-209		A	B	C	D	E	F	G	H	L	M	P	C	A	
3/16	0.33	1018357	-	.03	9.7	6.4	22.4	4.8	15.2	14.2	24.9	37.3	4.1	29.0	4.8	1.50	1.50	
1/4	0.5	1018375	1018384	.05	11.9	7.9	28.7	6.4	19.8	15.7	32.5	46.7	4.8	36.3	6.4	1.50	1.50	
5/16	0.75	1018393	1018400	.09	13.5	9.7	30.7	7.9	21.3	19.1	37.1	53.1	5.6	43.4	7.9	3.30	1.50	
3/8	1	1018419	1018428	.14	16.8	11.2	36.8	9.7	26.2	23.4	45.5	63.5	6.4	52.3	9.7	3.30	1.50	
7/16	1.5	1018437	1018446	.17	19.1	12.7	42.9	11.2	29.5	26.9	51.8	73.9	7.9	60.2	11.2	3.30	1.50	
1/2	2	1018455	1018464	.33	20.6	15.7	47.8	12.7	33.3	30.0	58.7	83.3	9.7	68.3	12.7	3.30	1.50	
5/8	3.25	1018473	1018482	.62	26.9	19.1	60.5	15.7	42.9	38.1	74.4	106	11.2	84.8	17.5	6.35	1.50	
3/4	4.75	1018491	1018507	1.07	31.8	22.4	71.4	19.1	50.8	46.0	88.9	126	12.7	101	20.6	6.35	1.50	
7/8	6.5	1018516	1018525	1.64	36.6	25.4	84.1	22.4	57.9	53.3	103	148	12.7	114	24.6	6.35	1.50	
1	8.5	1018534	1018543	2.28	42.9	28.4	95.5	25.4	68.3	60.5	119	167	14.2	130	26.9	6.35	1.50	
1-1/8	9.5	1018552	1018561	3.36	46.0	31.8	108	29.5	73.9	68.1	131	190	16.0	152	31.8	6.35	1.50	
1-1/4	12	1018570	1018589	4.31	51.6	35.1	119	32.8	82.8	76.2	146	210	17.5	165	35.1	6.35	1.50	
1-3/8	13.5	1018598	1018605	6.14	57.2	38.9	133	36.1	91.9	84.1	162	233	19.1	176	38.1	6.35	3.30	
1-1/2	17	1018614	1018623	7.80	60.5	41.4	146	38.9	98.6	91.9	176	254	20.6	189	41.1	6.35	3.30	
1-3/4	25	1018632	1018641	12.6	73.2	50.8	178	46.7	127	106	224	313	25.4	233	57.2	6.35	3.30	
2	35	1018650	1018669	20.4	82.6	57.2	197	52.8	146	122	258	347	28.7	263	61.0	6.35	3.30	
2-1/2	55	1018678	1018687	38.9	105	69.9	267	69.1	184	148	324	455	35.1	335	79.5	6.35	6.35	

6:1 Design Factor. Maximum Proof Load is 2 times the Working Load Limit. For Working Load Limit reduction due to side loading applications, see Warnings & Applications.



G-2130 / S-2130



- Working Load Limit and Grade 6 permanently shown on every shackle.
- Forged, Quenched & Tempered, with alloy bolts.
- Hot-dip galvanized (G) or self colored (S). 85, 120, and 150-metric ton shackles are all hot-dip galvanized bows and the bolts are Dimetcoated® and painted red.
- Sizes 3/8 and below are mechanically galvanized.
- Fatigue rated to 20,000 cycles at 1-1/2 times the Working Load Limit (1/3t - 55t).
- Approved for use at -40° C (-40° F) to 204° C (400° F).
- Meets or exceeds all requirements of ASME B30.26.
- Shackles 85 metric tons and larger are individually proof tested to 2.0 times the working load limit.
- Type Approval certification in accordance with ABS 2016 Steel Vessel Rules ABS Guide for Certification of Lifting Appliances available. Certificates available when requested at time of order and may include additional charges.
- 3.1 Certification as standard available for charpy and statistical proof test from 3.25t up to 25 tons to DNV 2.7-1 and EN13889.
- Crosby 3.25t through 25t G-2130OC anchor shackles are type approved to DNV Certification Notes 2.7-1-Offshore Containers. These Crosby shackles are statistical proof and impact tested to 42 Joules (31 ft-lb) min. avg. at -20° C (-4° F). The tests are conducted by Crosby and 3.1 test certification is available upon request.
- All other 2130 shackles can meet charpy requirements of 42 Joules (31 ft-lb) avg at -20° C (-4° F) when requested at time of order.
- Meets the performance requirements of Federal Specification RR-C-271H, Type IVA, Grade A, Class 3, except for those provisions required of the contractor.
- Look for the Red Pin®... the mark of genuine Crosby quality.

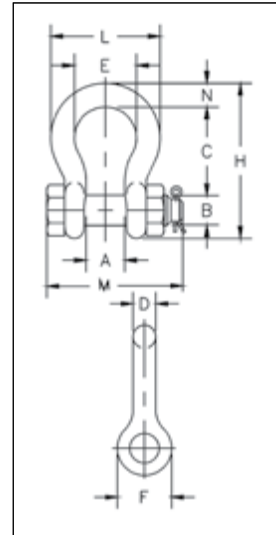

G-2130 / S-2130 Bolt Type Anchor Shackles

Nominal Size (in)	Working Load Limit (t)	Stock No.			Weight Each (kg)	Dimensions (mm)											Tolerance (+ / - mm)	
		G-2130	S-2130	G-2130OC		A	B	C	D	E	F	H	L	M	N	C	A	
3/16	0.33 ‡	1019464	-	-	.03	9.7	6.4	22.4	4.9	15.2	14.2	37.3	24.9	32.8	4.85		1.50	
1/4	0.5	1019466	-	-	.05	11.9	7.9	28.7	6.4	19.8	15.5	46.7	32.5	39.6	6.35	1.50	1.50	
5/16	0.75	1019468	-	-	.10	13.5	9.7	31.0	7.9	21.3	19.1	53.0	37.3	46.2	7.85	1.50	1.50	
3/8	1	1019470	-	-	.15	16.8	11.2	36.6	9.7	26.2	23.1	63.0	45.2	55.1	9.65	1.50	1.50	
7/16	1.5	1019471	-	-	.22	19.1	12.7	42.9	11.2	29.5	26.9	74.0	51.5	63.8	11.2	3.30	1.50	
1/2	2	1019472	1019481	-	.36	20.6	16.0	47.8	12.7	33.3	30.2	83.5	58.5	71.1	12.7	3.30	1.50	
5/8	3.25	1019490	1019506	1262013	.62	26.9	19.1	60.5	16.0	42.9	38.1	106	74.5	90.4	17.5	3.30	1.50	
3/4	4.75	1019515	1019524	1262022	1.23	31.8	22.4	71.5	19.1	51.0	46.0	126	89.0	105	20.6	3.30	1.50	
7/8	6.5	1019533	1019542	1262031	1.79	36.6	25.4	84.0	22.4	58.0	53.0	148	102	122	24.6	6.35	1.50	
1	8.5	1019551	1019560	1262040	2.28	42.9	28.7	95.5	25.4	68.5	60.5	167	119	137	26.9	6.35	1.50	
1-1/8	9.5	1019579	1019588	1262059	3.75	46.0	31.8	108	28.7	74.0	68.5	190	131	150	31.8	6.35	1.50	
1-1/4	12	1019597	1019604	1262068	5.31	51.5	35.1	119	31.8	82.5	76.0	210	146	170	35.1	6.35	1.50	
1-3/8	13.5	1019613	1019622	1262077	7.18	57.0	38.1	133	35.1	92.0	84.0	233	162	183	38.1	6.35	3.30	
1-1/2	17	1019631	1019640	1262086	8.62	60.5	41.4	146	38.1	98.5	92.0	254	175	196	41.1	6.35	3.30	
1-3/4	25	1019659	1019668	1262095	15.4	73.0	51.0	178	44.5	127	106	313	225	246	57.0	6.35	3.30	
2	35	1019677	1019686	-	23.7	82.5	57.0	197	51.0	146	122	348	253	275	61.0	6.35	3.30	
2-1/2	55	1019695	1019702	-	44.6	105	70.0	267	66.5	184	145	453	327	345	79.5	6.35	6.35	
3	† 85	1019711	-	-	70	127	82.5	330	76.0	200	165	546	365	384	92.0	6.35	6.35	
3-1/2	† 120 ‡	1019739	-	-	120	133	95.5	372	92.0	229	203	626	419	432	105	6.35	6.35	
4	† 150 ‡	1019757	-	-	153	140	108	368	104	254	229	653	468	451	116	6.35	6.35	

6:1 Design Factor. Maximum Proof Load is 2 times the Working Load Limit. For Working Load Limit reduction due to side loading applications, see Warnings & Applications..

† Individually Proof Tested with certification. ‡ Furnished with eye bolts for handling.

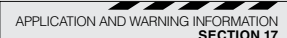

G-2150 / S-2150



- Working Load Limit and Grade 6 permanently shown on every shackle.
- Forged, Quenched & Tempered, with alloy pins.
- Hot-dip galvanized (G) or self-colored (S). 85 ton shackles have hot-dip galvanized bows and the bolts are Dimetcoated® and painted red.
- Sizes 3/8 inch and below are mechanically galvanized.
- Fatigue rated to 20,000 cycles at 1-1/2 times the Working Load Limit. (1/2t - 55t).
- Approved for use at -40° C (-40 degrees F) to 204° C (400° F).
- Meets or exceeds all requirements of ASME B30.26.
- Sizes 1/2 - 25t meet the performance requirements of EN13889:2003.
- Shackles 55 metric tons and smaller can be furnished proof tested with certificates to designated standards, such as ABS, DNV, Lloyds, or other certification when requested at time of order.
- Type Approval certification in accordance with ABS 2016 Steel Vessel Rules and 2016 ABS Guide for Certification of Lifting Appliance. Certificates available when requested at time of order and may include additional charges.
- Meets the performance requirements of Federal Specification RR-C-271H, Type IVB, Grade A, Class 3, except for those provisions required of the contractor.
- All 2150 shackles can meet charpy requirements of 42 Joules (31 ft-lb) avg at -20° C (-4° F) upon special request.
- Look for the Red Pin®... the mark of genuine Crosby quality.

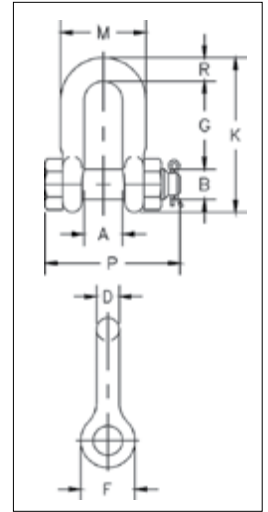

G-2150 / S-2150 Bolt Type Chain Shackles

Nominal Size (in)	Working Load Limit (t)*	Stock No.		Weight Each (kg)	Dimensions (mm)										Tolerance (+ / - mm)	
		G-2150	S-2150		A	B	D	F	G	K	M	P	R	G	A	
1/4	0.5	1019768	-	.06	11.9	7.9	6.4	15.5	19.1	40.4	24.6	39.6	6.35	1.50	1.50	
5/16	0.75	1019770	-	.10	13.5	9.7	7.9	19.1	25.4	48.5	29.5	46.2	7.85	1.50	1.50	
3/8	1	1019772	-	.15	16.8	11.2	9.7	23.1	31.0	58.5	35.8	55.0	9.65	3.30	1.50	
7/16	1.5	1019774	-	.22	19.1	12.7	11.2	26.9	36.1	67.5	41.1	63.5	11.2	3.30	1.50	
1/2	2	1019775	1019784	.34	20.6	16.0	12.7	30.2	41.4	77.0	46.0	71.0	12.7	3.30	1.50	
5/8	3.25	1019793	1019800	.67	26.9	19.1	16.0	38.1	51.0	95.5	58.5	89.5	16.0	3.30	1.50	
3/4	4.75	1019819	1019828	1.14	31.8	22.4	19.1	46.0	60.5	115	70.0	103	20.6	6.35	1.50	
7/8	6.5	1019837	1019846	1.74	36.6	25.4	22.4	53.0	71.5	135	81.0	120	24.6	6.35	1.50	
1	8.5	1019855	1019864	2.52	42.9	28.7	25.4	60.5	81.0	151	93.5	135	25.4	6.35	1.50	
1-1/8	9.5	1019873	1019882	3.45	46.0	31.8	28.7	68.5	91.0	172	103	150	31.8	6.35	1.50	
1-1/4	12	1019891	1019908	4.90	51.5	35.1	31.8	76.0	100	191	115	165	35.1	6.35	1.50	
1-3/8	13.5	1019917	1019926	6.24	57.0	38.1	35.1	84.0	111	210	127	183	38.1	6.35	3.30	
1-1/2	17	1019935	1019944	7.72	60.5	41.4	38.1	92.0	122	230	137	196	41.1	6.35	3.30	
1-3/4	25	1019953	1019962	14.2	73.0	51.0	44.5	106	146	279	162	230	54.0	6.35	3.30	
2	35	1019971	1019980	21.2	82.5	57.0	51.0	122	172	312	184	264	60.0	6.35	3.30	
2-1/2	55	1019999	1020004	38.6	105	70.0	66.5	145	203	377	238	344	66.5	6.35	6.35	
3	† 85	1020013	-	56	127	82.5	76.0	165	216	429	279	419	89.0	6.35	6.35	

6:1 Design Factor. Maximum Proof Load is 2 times the Working Load Limit. For Working Load Limit reduction due to side loading applications, see Warnings & Applications.
 † Individually Proof Tested with certification.

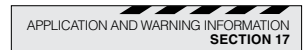

G-209A
Grade 8



- Forged alloy steel, Quenched & Tempered, with alloy pins.
- Meets performance requirements of Grade 8 shackles.
- Working Load Limit permanently shown on every shackle.
- Hot-dip galvanized.
- Size 3/8 inch is mechanically galvanized.
- Shackles can be furnished proof tested with certificates to designated standards, such as ABS, DNV, Lloyds, or other certification. Charges for proof testing and certification available when requested at the time of order.
- Approved for use at -40° C (-40° F) to 204° C (400° F).
- Meets or exceeds all requirements of ASME B30.26 including identification, ductility, design factor, proof load and temperature requirements. Importantly, these shackles meet other critical performance requirements including impact properties and material traceability, not addressed by ASME B30.26.
- G-209A Screw pin anchor shackles meet the performance requirements of Federal Specification RR-C-271H, Type IVA, Grade B, Class 2, except for those provisions required of the contractor.

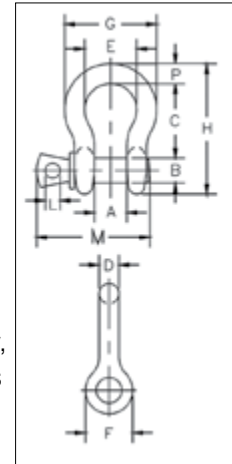

G-209A Alloy Screw Anchor Pin Shackles



APPLICATION AND WARNING INFORMATION
SECTION 17

Nominal Size (in)	Working Load Limit (t)	Stock No.	Weight Each (kg)	Dimensions (mm)												Tolerance (+/- mm)	
				A	B	C	D	E	F	G	H	L	M	P	C	A	
3/8	2	1017450	.14	16.8	11.2	36.6	9.65	26.2	23.1	45.2	63.5	6.35	51.5	9.65	3.30	1.50	
7/16	2.67	1017472	.17	19.1	12.7	42.9	11.2	29.5	26.9	51.5	74.0	7.85	60.5	11.2	3.30	1.50	
1/2	3.33	1017494	.29	20.6	16.0	47.8	12.7	23.3	30.2	58.5	83.5	9.65	68.5	12.7	3.30	1.50	
5/8	5	1017516	.63	26.9	19.1	60.5	16.0	42.9	38.1	74.5	106	11.2	85.0	17.5	3.30	1.50	
3/4	7	1017538	1.02	31.8	22.4	71.5	19.1	51.0	46.0	89.0	126	12.7	101	20.6	6.35	1.50	
7/8	9.5	1017560	1.53	36.6	25.4	84.0	22.4	58.0	53.0	102	148	12.7	114	24.6	6.35	1.50	
1	12.5	1017582	2.41	42.9	28.7	95.5	25.4	68.5	60.5	119	167	14.2	129	26.9	6.35	1.50	
1-1/8	15	1017604	3.09	46.0	31.8	108	29.5	74.0	68.5	131	190	16.0	142	31.8	6.35	1.50	
1-1/4	18	1017626	4.31	51.5	35.1	119	32.8	82.5	76.0	146	210	17.5	156	35.1	6.35	1.50	
1-3/8	21	1017648	6.01	57.0	38.1	133	36.1	92.0	84.0	162	233	19.1	174	38.1	6.35	3.30	

4.5:1 Design Factor. Maximum Proof Load is 2 times the Working Load Limit (metric tons) and 2.2 times the Working Load Limit (short tons). For Working Load Limit reduction due to side loading applications, see Warnings & Applications.

G-2169



- Quenched & Tempered for maximum strength.
- Forged alloy steel.
- Available in galvanized (G) and self colored (S) finish.
- Can be individually proof tested and magnetic particle inspected upon request. Crosby certification available at time of order.
- Meets or exceeds all requirements of ASME B30.26 including identification, ductility, design factor, proof load and temperature requirements. Importantly, these shackles meet other critical performance requirements including fatigue life, impact properties and material traceability, not addressed by ASME B30.26.
- Look for the Red Pin®... the mark of genuine Crosby quality.

S-2169

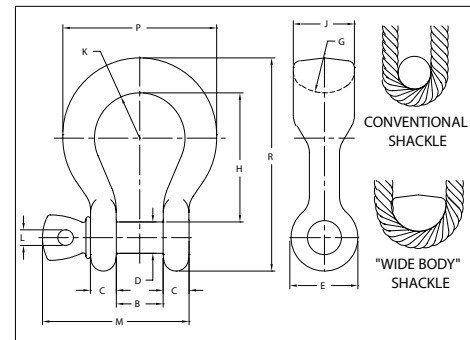

G-2169 / S-2169 Alloy Screw Pin Wide Body Shackles



APPLICATION AND WARNING INFORMATION
SECTION 17

Working Load Limit (t)	G-2169 Stock No.	S-2169 Stock No.	Weight Each (kg)	Dimensions (mm)											
				B +/- .25	C	D +/- .02	E	G	H	J	K	L	M	P	R
7	1021655	1021664	1.6	31.8	17.5	22.4	46.2	31.8	90.4	40.6	31.8	12.7	101	104	149
12.5	1021673	1021682	4.0	42.9	23.4	28.7	60.5	34.8	118	54.1	41.4	14.2	130	140	194
18	1021691	1021699	5.9	51.6	29.5	35.1	68.3	38.1	148	63.5	50.8	17.5	159	172	238

5:1 Design Factor. Proof Load is 2 times the Working Load Limit.

G-2140 / S-2140

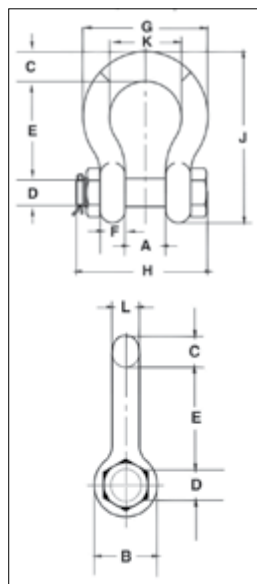

- Quenched & Tempered.
- Alloy bows, alloy bolts.
- Forged alloy steel 2 through 250 metric tons. Cast alloy steel 400 metric tons.
- Meets performance requirements of Grade 8 shackles.
- Working Load Limit is permanently shown on every shackle.
- 30, 40, 55, and 85 metric ton shackle bows are available galvanized (G) or self colored (S) with bolts that are galvanized and painted red.
- Size 3/8 inch is mechanically galvanized.
- 120, 150, 175 metric ton shackle bows are hot-dip galvanized; bolts are Dimetcoated and painted red.
- 200, 250, 300, 400 metric ton shackle bows are Dimetcoated; bolts are Dimetcoated and painted red.
- Approved for use at -40° C (-40° F) to 204° C (400° F).
- Shackles are Quenched & Tempered and can meet DNV impact requirements of 42 Joules (31 ft-lb) at -20° C (-4° F).
- Crosby COLD TUFF® shackles that meet the additional requirements of DNV rules for certification of lifting applications - loose gear are available.
- Shackles 200 metric tons and larger are provided as follows:
 - Serialized bolt and bow
 - Material certification (chemical)
 - Magnetic particle inspected.
 - Certification must be requested at time of order.
- Meets or exceeds all requirements of ASME B30.26 including identification, ductility, design factor, proof load and temperature requirements. 2140 shackles meet other critical performance requirements including impact properties and material traceability, not addressed by ASME B30.26.
- Type Approval certification in accordance with ABS 2016 Steel Vessel Rules and 2016 ABS Guide for Certification of Lifting Appliances. Certificates are available when requested at time of order and may include additional charges.
- G-2140 meets the performance requirements of Federal Specification RR-C-271H, Type IVA, Grade B, Class 3, except for those provisions required of the contractor. For additional information, see Warnings & Applications.
- Look for the Red Pin®... the mark of genuine Crosby quality.

G-2140 / S-2140 Alloy Bolt Type Anchor Shackles

Nominal Shackle Size (in)	Working Load Limit (t)	Stock No.			Weight Each (kg)	Dimensions (mm)													Tolerance (+ / - mm)		
		G-2140	S-2140	G-2140OC		A	B	C	D	E	F	G	H	J	K	L	M	N	A	D	E
3/8	2	1021015	-	-	0.15	16.8	23.1	9.7	11.2	36.6	9.7	45.2	55.1	63.2	26.2	9.7	-	-	1.5	0.3	3.3
7/16	2.67	1021020	-	-	0.22	19.1	26.9	11.2	12.7	42.9	10.4	51.6	63.8	73.9	29.5	11.2	-	-	1.5	0.3	3.3
1/2	3.33	1021029	-	-	0.36	20.6	30.2	12.7	16.3	47.8	11.7	58.7	71.1	83.3	33.3	12.7	-	-	1.5	0.5	3.3
5/8	5	1021038	-	-	0.76	26.9	38.1	17.5	19.6	60.5	14.7	74.7	90.4	106.4	42.9	16.0	-	-	1.5	0.5	3.3
3/4	7	1021047	-	-	1.23	31.8	46.0	20.6	22.6	71.4	17.5	88.9	105.4	126.2	50.8	19.1	-	-	1.5	0.5	6.4
7/8	9.5	1021056	-	-	1.79	36.6	53.1	24.6	25.9	84.1	20.6	102.4	122.4	148.1	57.9	22.4	-	-	1.5	0.5	6.4
1	12.5	1021065	-	-	2.57	42.9	60.5	26.9	29.2	95.3	23.4	119.1	136.9	166.6	68.3	25.4	-	-	1.5	0.5	6.4
1-1/8	15	1021074	-	-	3.75	46.0	68.3	31.8	31.8	108.0	26.4	131.1	149.9	189.7	73.9	28.7	-	-	1.5	0.5	6.4
1-1/4	18	1021083	-	-	5.31	51.6	76.2	35.1	35.6	119.1	29.5	146.1	169.9	209.6	82.6	32.8	-	-	1.5	0.8	6.4
1-3/8	21	1021092	-	-	7.18	57.2	84.1	38.1	38.9	133.4	32.5	162.1	183.1	232.7	92.2	36.1	-	-	3.3	0.8	6.4
1-1/2	30	1021110	1021129	1262407	8.52	60.5	91.9	41.1	41.4	146	35.3	175	196	254	98.6	38.9	-	-	3.3	0.8	6.4
1-3/4	40	1021138	1021147	1262416	15.4	73.2	106	57.2	50.8	178	44.5	224	237	313	127	46.7	-	-	3.3	0.8	6.4
2	55	1021156	1021165	1262425	23.6	82.6	122	61.0	57.2	197	50.8	258	264	347	146	52.8	-	-	3.3	0.8	6.4
2-1/2	85	1021174	1021183	1262434	43.5	105	148	79.2	69.9	267	66.5	324	345	455	184	68.8	-	-	6.4	0.8	6.4
3	120	1021192	-	1262443	81	127	165	92.2	82.6	330	76.2	371	384	546	200	79.2	-	-	6.4	1.0	6.4
3-1/2	† 150	1021218	-	1262452	120	133	203	111	95.3	372	95.3	432	448	632	229	91.9	102	46	6.4	0.3	6.4
4	† 175	1021236	-	1262461	153	140	229	116	108	368	102	457	517	652	254	102	102	46	6.4	0.3	6.4
4-3/4	† 200	1021234	-	-	209	184	267	127	121	386	116	529	611	706	279	121	102	46	6.4	0.3	6.4
5	† 250	1021243	-	-	276	216	305	143	127	470	123	600	632	828	330	127	102	46	4.0	0.3	1.8
6	† 300	1021252	-	-	362	213	330	154	152	475	124	629	666	871	330	149	102	46	4.0	0.3	1.8
7*	† 400	1021478	-	-	500	210	356	184	178	572	165	660	728	1022	330	152	102	46	6.4	0.3	6.4

4.5:1 Design Factor for sizes 2 through 21 metric tons, 5.4:1 Design Factor for sizes 30 through 175 metric tons, 4:1 Design Factor for 200 through 400 metric tons. Maximum Proof Load is 2 times the Working Load Limit. *Cast alloy steel. †Furnished with round head bolts with a handle. For Working Load Limit reduction due to side loading applications, see Warnings & Applications.

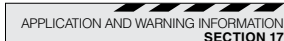

G-2160 / S-2160



- Increase in shackle bow radius provides minimum 58% gain in sling bearing surface and eliminates need for a thimble.
- Increases usable sling strength a minimum of 15% and greatly improves life of wire rope slings.
- Can be used to connect synthetic web slings, synthetic round slings or wire rope slings.
- All sizes Quenched & Tempered for maximum strength.
- Forged alloy steel from 7 through 300 metric tons.
- Cast alloy steel from 400 through 1550 metric tons.
- Proof tested as follows:
 - 7 through 75 metric tons and 200 through 300 metric tons: 2 x WLL
 - 125 metric tons: 1.6 x WLL
 - 400 metric tons and higher: 1.33 x WLL
- All ratings are in metric tons, embossed on side of bow.
- G-2160, (7 through 55t), are hot-dip galvanized and pins are painted red.
- G-2160 (75t and larger), bows are furnished Dimetcoated; Pins are Dimetcoated, then painted red.
- S-2160 bows and pins are painted red.
- Approved for use at -40° C (-40° F) to 204° C (400° F).
- Bow and bolt are certified to meet Charpy impact testing of 42 Joules (31 ft-lb) min. avg. at -20° C (-4° F).
- All 2160 shackles are individually proof tested and magnetic particle inspected. Crosby certification available at time of order.
- Shackles requiring ABS, Lloyds and other certifications are available upon special request and must be specified at time of order.
- Type approved and certification to DNV Rules for Certification of Lifting Appliances, and are produced in accordance with DNV MSA requirements. Databook is provided that includes required documents.
 - Serialization / Identification
 - Material Testing (physical / chemical / Charpy)
 - Proof Testing
- Look for the Red Pin®... the mark of genuine Crosby quality.

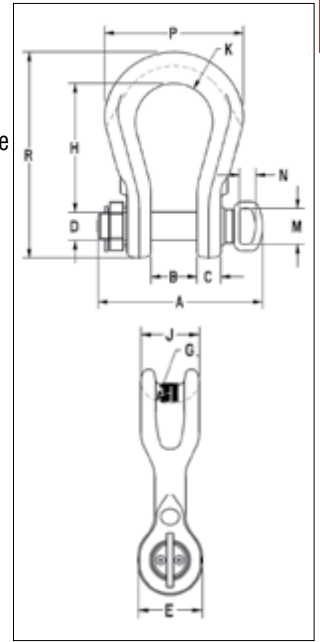

G-2160 / S-2160 Wide Body Shackles

Working Load Limit (t)*	Stock No.		Weight Each (kg)	Dimensions (mm)													Effective Body Diameter
	G-2160	S-2160		A	B +/- 6.35	C	D +/- .5	E	G	H	J	K	M	N	P	R	
7	1021256	1021548	1.81	105	31.8	17.5	22.4	46.2	31.8	90.4	40.6	31.8	-	-	104	149	53.3
12.5	1021265	1021557	4.54	137	42.9	23.4	28.7	60.5	34.8	118	54.1	41.4	-	-	140	194	61.0
18	1021274	1021566	6.8	170	51.6	29.5	35.1	68.3	38.1	148	63.5	50.8	-	-	172	238	71.1
30	1021283	1021575	11.34	195	60.2	35.1	41.4	88.9	63.5	176	79.5	63.5	-	-	216	289	104
40	1021285	1021584	20.9	236	73.2	42.9	50.8	102	44.4	205	95.3	76.2	-	-	270	346	91.4
55	1021287	1021593	32.21	263	82.6	50.8	57.2	118	66.8	238	114	88.9	-	-	311	397	109
75	1022101	-	51	382	105	60.7	69.9	136	95.3	293	127	92.5	102	45.7	321	474	160
125	1022110	-	87	465	130	78.7	80.0	165	95.3	365	150	110	102	45.7	393	584	173
200	1022118	-	191	491	150	86.1	105	214	133	480	217	138	102	45.7	515	773	241
300	1022127	-	365	574	187	109	133	267	156	600	264	160	102	45.7	608	957	290
400	1021334	-	518	772	220	131	160	320	203	575	320	185	102	45.7	690	985	363
500	1021343	-	653	849	250	146	180	340	205	630	340	225	102	45.7	790	1085	376
600	1021352	-	967	916	275	158	200	394	330	700	370	247	146	57.2	865	1200	516
700	1021361	-	1170	990	300	167	215	433	223	735	400	270	146	57.2	940	1275	422
800	1021254	-	1372	1059	325	185	230	449	248	750	420	277	146	57.2	975	1323	457
900	1021389	-	1712	1112	350	198	250	478	330	757	440	293	146	57.2	1025	1387	569
1000	1021370	-	1850	1169	380	212	270	508	261	760	460	308	146	57.2	1075	1405	490
1250	1021272	-	2588	1278	432	233	300	573	354	930	530	323	-	-	1175	1660	620
1550	1021281	-	3650	1588	465	282	320	616	318	1075	580	338	-	-	1316	1896	693

5:1 Design Factor on 75 through 300 metric tons. Maximum Proof Load is 2 times the Working Load Limit on 75 through 300 metric tons (except for 125 metric tons which is proof tested to 1.6 times the Working Load Limit). 4.5:1 Design Factor on 400 through 1550 metric tons. Maximum Proof Load is 1.33 times the Working Load Limit on 400 through 1550 metric tons.

