

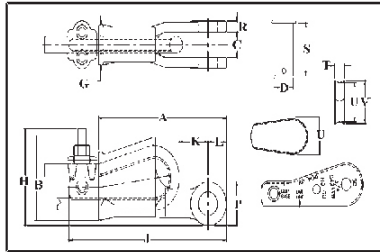

**WARNING**  
 DO NOT EXCEED WORKING LOAD LIMIT.  
 USE CERTIFIED RIGGING WITH RIGHT SIZE OF WIRE ROPE

## Wedge Socket



Wedge sockets meet the performance requirements of Federal Specification RR-S-550D, Type C, except those provisions required of the contractor.



**SL-421**

Wire Rope Dia. (mm.)	Weight Each (kg.)	Wedge Only Weight Each (kg)	Dimensions (mm)																
			A	B	C	D	G	H	J†	K†	L	P	R	S	T	U	V		
9-10	1.44	.23	143	70.5	20.6	20.6	35.1	79.0	187	40.6	22.4	39.6	11.2	54.1	11.2	31.8	35.1		
11-13	2.79	.48	173	90.0	25.4	25.4	41.1	98.0	222	30.7	26.9	49.3	12.7	62.0	13.5	44.5	47.8		
14-16	4.40	.81	207	111	31.8	30.2	54.0	116	263	41.7	31.0	57.0	14.2	79.5	17.5	51.0	55.5		
18-19	6.58	1.18	248	122	38.1	35.1	62.0	136	306	55.0	35.6	66.5	16.8	92.2	19.8	59.5	65.0		
20-22	9.75	1.82	283	118	44.5	41.4	68.5	160	356	56.5	42.2	79.0	19.1	106	22.4	68.5	74.5		
24-26	13.9	2.44	324	129	51.0	51.0	65.0	178	403	69.0	51.0	95.5	22.4	118	26.2	73.0	83.5		
28	20.5	3.56	365	140	57.0	57.0	84.0	197	450	63.5	57.0	108	25.4	137	30.2	79.5	90.5		
30-32	26.1	3.09	406	202	63.5	63.5	90.5	N/A	N/A	86.0	63.5	121	28.4	148	33.3	86.0	97.0		

NOTE: For intermediate wire rope sizes, use next larger size socket.

Specifications given are indicative and are subject to change.

## Resin for Spelter Sockets

Note: For use on 416 & 417 Spelter socket only.

- 100% termination efficiency.
- Temperature operating range is -54° C to +115° C.
- Ideal for on site applications.
- No hazardous molten metal.
- Improved fatigue life.
- Pouring temperature without booster pack is 9° C to 43° C.
- One booster pack if pouring temperature is 0° C to 9° C.
- Two booster packs if pouring temperature is -10° C to 0° C.
- Refer to WIRELOCK® Technical Manual for more information.

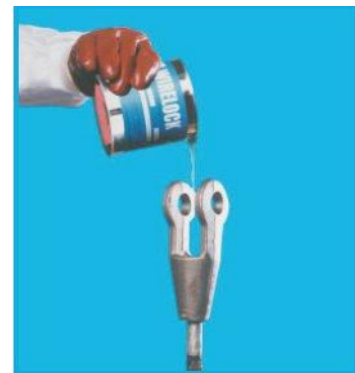

### Guide to amount of WIRELOCK® Required



Wire Rope Size	WIRELOCK® Required (cc)	Wire Rope Size	WIRELOCK® Required (cc)
6-7	9	44	700
8	17	48	700
9-10	17	51	1265
11	35	54	1265
13	35	56	1410
14	52	60	1410
16	52	64	1830
20	86	67	1830
22	125	70	2250
26	160	76	3160
28	210	82	3795
32	350	88	4920
36	350	94	5980
40	420	102	7730
42	495		