

**WARNING**  
DO NOT EXCEED WORKING LOAD LIMIT.  
USE CERTIFIED RIGGING WITH RIGHT SIZE OF WIRE ROPE & CHAIN



# Safe Lifters

Pundol Apartments, Shop No. 5 & 6, 160 M.G. Road,  
Pune - 411001, (India) Tel +91 20 66013783 / 84 / 85 / 86  
Fax +91 20 26350832 Email : safelifters@eth.net

## Turn Buckles

### Federal Specification FF-T-791B, Type 1



**SL-223**  
**HOOK & HOOK**



**SL-225**  
**HOOK & EYE**



**SL-226**  
**EYE & EYE**



**SL-227**  
**JAW & EYE**



**SL-228**  
**JAW & JAW**

Nominal size *	I <sub>1</sub> mm	I <sub>2</sub> mm	m mm	e mm	a mm	b mm	f mm	w mm	h mm	g inch	k mm	Working Load Limit ( Kg )		Weight Per Piece (Kg)		
												Eye & Eye	Hook & Hook	Eye & Eye	Jaw & Eye	Jaw & Jaw
inch												Eye & Eye	Hook & Eye	Hook & Eye		
3/8X 6	180	152	12	129	28	13	137	12	22	1 5/16	137	540	450	0,39	0,42	0,45
1/2X 6	190	152	15	147	36	18	153	16	27	1 3/8	147	1000	680	0,67	0,72	0,76
1/2X 9	266	228	15	187	36	18	193	16	27	1 3/8	187	1000	680	0,84	0,89	0,93
1/2X 12	342	304	15	222	36	18	228	16	27	1 3/8	222	1000	680	1,01	1,06	1,10
5/8X 6	200	152	20	166	44	22	177	19	33	1 1/2	161	1590	1020	1,07	1,16	1,25
5/8X 9	276	228	20	206	44	22	217	19	33	1 1/2	201	1590	1020	1,31	1,40	1,49
5/8X 12	352	304	20	241	44	22	252	19	33	1 1/2	236	1590	1020	1,55	1,64	1,73
5/8X 18	505	457	-	-	-	-	-	19	33	1 1/2	316	1590	-	-	-	2,21
3/4X 6	210	152	23	181	54	25	196	23	38	1 5/8	173	2360	1360	1,75	1,89	2,03
3/4X 9	287	228	23	221	54	25	236	23	38	1 5/8	213	2360	1360	2,09	2,23	2,37
3/4X 12	362	304	23	256	54	25	271	23	38	1 5/8	248	2360	1360	2,42	2,56	2,70
3/4X 18	515	457	23	336	54	25	351	23	38	1 5/8	328	2360	1360	3,08	3,22	3,36
7/8X 12	372	304	26	273	60	31	287	28	44	1 3/4	266	3270	1810	3,56	3,80	4,04
7/8X 18	524	457	26	353	60	31	367	28	44	1 3/4	346	3270	1810	4,43	4,67	4,91
1 x 12	381	304	29	286	76	36	323	30	52	1 7/8	286	4540	2270	5,05	5,33	5,61
1 x 18	533	457	29	366	76	36	403	30	52	1 7/8	366	4540	2270	6,25	6,53	6,81
1 1/4X 12	387	304	-	-	90	46	360	44	71	1 1/8	330	6890	-	8,60	9,20	9,80
1 1/4X 18	540	457	-	-	90	46	440	44	71	1 1/8	380	6890	-	10,40	11,00	11,60
1 1/4X 24	693	610	-	-	90	46	495	44	71	1 1/8	479	6890	-	12,20	12,90	13,60
1 1/2X 12	400	304	-	-	104	54	390	52	71	1 3/8	360	9710	-	13,20	14,30	15,40
1 1/2X 18	550	457	-	-	104	54	465	52	71	1 3/8	430	9710	-	15,82	16,92	18,02
1 1/2X 24	703	610	-	-	104	54	540	52	71	1 3/8	496	9710	-	18,00	18,70	19,30
1 3/4X 18	570	457	-	-	-	-	60	86	1 3/4	440	12700	-	-	-	-	23,56
1 3/4X 24	720	610	-	-	117	59	577	60	86	1 3/4	500	12700	-	26,00	27,50	26,81
2 x 24	735	610	-	-	143	67	632	64	95	2 3/8	540	16780	-	37,58	40,80	45,04
2 1/2X 24	800	610	-	-	-	-	73	113	2 1/2	580	27220	-	-	-	-	72,32

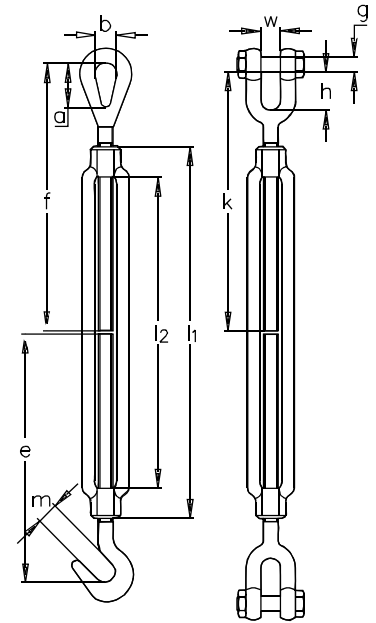

TURNBUCKLES RECOMMENDED FOR STRAIGHT OR IN-LINE PULL ONLY.

\* Proof load is 2 times Working Load Limit. Ultimate Load is 5 times Working Load Limit.  
Specifications given are indicative and are subject to change.

- Galvanized steel.
- Turnbuckle eyes are forged and elongated, by design, to maximize easy attachment in system and minimize stress in the eye. For turnbuckle size 1/4" through 2 1/2" a shackle one size smaller can be reeved through eye.
- Modified BSW thread for improved fatigue properties.
- Lock Nuts available for all sizes
- End fittings are Quenched and Tempered, bodies heat treated by normalizing