

⚠ WARNING

DO NOT EXCEED WORKING LOAD LIMIT.
USE ONLY G80 & G100 COMPATIBLE COMPONENTS FOR OVERHEAD LIFTING.



Safe Lifters

Pundol Apartments, Shop No. 5 & 6, 160 M.G. Road,
Pune - 411001. (India) Tel +91 20 66013783 / 84 / 85 / 86
Fax +91 20 26350832 Email : safelifters@eth.net



Swivels Eye - Eye

- **Material** : High tensile steel, Quenched and Tempered
- **Safety factor** : MBL equals 4 x WLL
- **Standard** : generally to RR-C-271, Type VII, Class 2
- **Certification** : test certificates can be supplied upon request

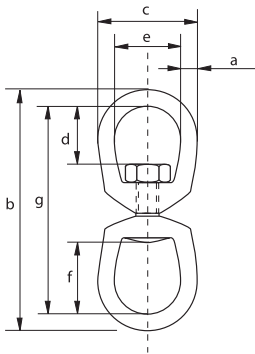

working load limit	diameter	length outside	width outside	length inside	width inside	length inside	length	weight per pc
tons	a mm	b mm	c mm	d mm	e mm	f mm	g mm	kg
0.39	6	87	32	17	19	27	75	0.1
0.57	8	106	41	21	25	32	90	0.18
1.02	10	130	51	24	32	38	110	0.32
1.6	13	164	64	33	38	51	138	0.6
2.4	16	199	76	40	44	60	167	1.13
3.3	19	221	89	44	51	67	183	1.82
4.5	22	257	102	52	57	78	213	2.83
5.7	25	295	114	59	64	89	245	4.06
8.2	32	355	143	68	80	94	291	7.43
20.5	38	511	178	106	102	106	435	20.8



Swivels Jaw - Eye

- **Material** : High tensile steel, Quenched and Tempered
- **Safety factor** : MBL equals 4 x WLL
- **Standard** : generally to RR-C-271, Type VII, Class 3
- **Certification** : test certificates can be supplied upon request

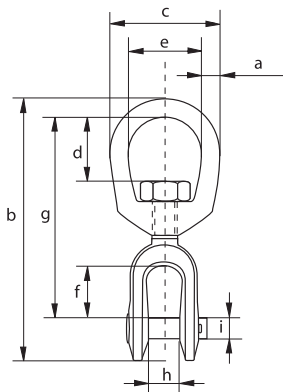

working load limit	diameter	length	width outside	length inside	width inside	length inside	length	width inside	diameter pin	weight per pc
tons	a mm	b mm	c mm	d mm	e mm	f mm	g mm	h mm	i mm	kg
0.39	6	86	32	17	19	22	67	12	6	0.11
0.57	8	98	41	21	25	22	75	13	8	0.17
1.02	10	121	51	24	32	27	92	16	10	0.32
1.6	13	154	64	33	38	33	114	19	13	0.65
2.4	16	186	76	40	44	38	135	24	16	1.12
3.3	19	211	89	44	51	44	154	28	19	1.76
4.5	22	242	102	52	57	52	178	30	22	2.66
5.7	25	297	114	59	64	71	217	44	28	4.46
8.2	32	341	143	68	80	71	248	52	35	7.14
20.5	38	529	178	106	102	112	375	73	57	24.8