

⚠ WARNING

DO NOT EXCEED WORKING LOAD LIMIT.
USE ONLY G80 & G100 COMPATIBLE COMPONENTS FOR OVERHEAD LIFTING.



Safe Lifters

Pundol Apartments, Shop No. 5 & 6, 160 M.G. Road,
Pune - 411001. (India) Tel +91 20 66013783 / 84 / 85 / 86
Fax +91 20 26350832 Email : safelifters@eth.net

Grade 30 Eye Hoist Hook with safety latch

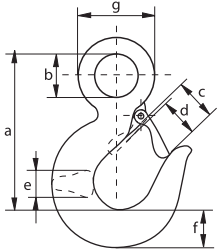

- **Material** : Carbon steel
- **Safety factor** : MBL equals 4 x WLL

working load limit	length	diameter eye inside	width opening	width opening	thickness	width	diameter eye outside	weight per pc
tons	a mm	b mm	c mm	d mm	e mm	f mm	g mm	kg
0.8	82	19	24	20	15	20	38	0.27
1	93	25	26	22	18	22	45	0.4
1.6	103	28	27	23	20	27	52	0.55
2	120	32	32	27	23	30	60	0.83
3.2	147	40	41	35	29	38	74	1.9
5	187	51	51	43	37	46	97	3.5
7.5	230	64	61	53	46	58	122	6.9
10	256	72	65	58	58	66	136	10.5
15	318	90	85	78	63	77	168	17.5

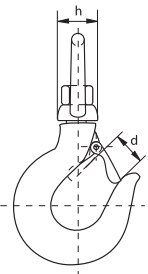
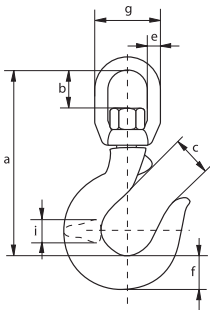

Grade 80 Swivel Hoist Hook with safety latch

- **Material** : Carbon steel
- **Safety factor** : MBL equals 4 x WLL

working load limit	length	length inside	width opening	width opening	diameter	width	diameter	width	thickness	weight per pc
tons	a mm	b mm	c mm	d mm	e mm	f mm	g mm	h mm	i mm	kg
0.8	116	28	24	20	11	20	52	30	15	0.45
1	145	36	26	22	14	22	67	36	18	0.9
1.6	165	49	27	23	17	27	81	42	20	1.3
2	175	45	32	27	17	30	81	42	23	1.6
3.2	214	55	41	35	21	38	106	64	29	3.8
5	264	70	51	43	26	46	129	77	37	6.9
7.5	308	74	61	53	29	58	148	92	46	10.6
10	344	86	65	58	35	66	165	105	58	16
15	427	114	85	78	40	77	200	130	63	27
20	505	125	90	82	48	90	235	146	82	60